

# SUMMER

## MAILING ADDRESS CHANGES

- All 1st class mail, with the exception of magazines and other subscriptions, will automatically be forwarded to your permanent address.
- If your permanent address has changed, please update your records with the Registrar's Office in Old Main.
- Update the mailing address of your online shopping such as Amazon, DoorDash, etc., ship-to-home deliveries from Walmart, etc., and credit card companies to your summer mailing address.



# Ford, McKinney, & Weller Halls

## ROOM FURNITURE

Be sure to move room furniture to the locations defined in the diagram

### DESKS

- Set flush with wall
- Hutches are permanently affixed to desks
- Final placement of desks should resemble the diagram(s) shown on this poster

### BEDS

- Should be unbunked
- Guard rails out
- Set flush with wall
- Final placement of beds should resemble the diagram(s) shown on this poster

### DRESSERS

- Bookcases (D) should be stacked on top of dressers (E)
- Set flush with the wall
- Final placement of dressers should resemble the diagram(s) shown on this poster

### MAKE SURE TO...

- Use the pins to couple furniture pieces together
- You may request additional pins from your front desk at no charge
- You will not be allowed to check out until all your room furniture is moved to the locations defined in the diagram with the pins in the proper place
- Please be aware that failure to reset your room may result in a \$100 improper checkout charge

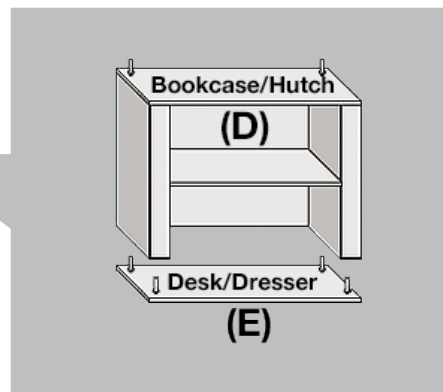

#### Double Room:

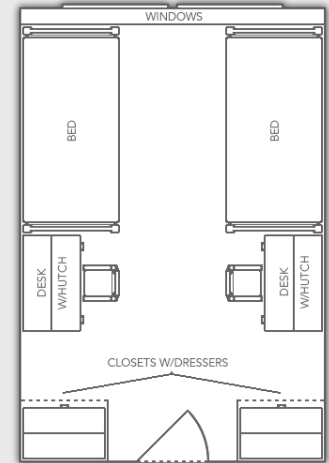

#### Triple Room:

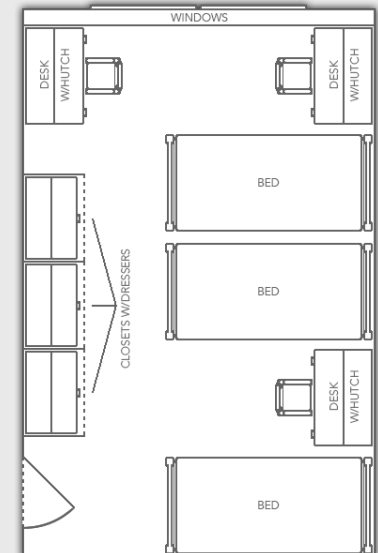

Layouts not to scale.